



AC20 DO
Wood-Aluminium Door



TREND-SETTING. SAFE.

The AC20 DO wood-aluminium door combines an incomparable feel-good experience with luxuriously appealing design. The system is used primarily in public buildings such as schools or kindergartens, as the outward-opening door system can be configured as an anti-panic or emergency exit door (in accordance with DIN 179, DIN 1125) with controlled automatic access as an additional security function.

The cosy warmth of the wooden frame on the inside creates a feel-good atmosphere in your entrance area, in a way that only wood-aluminium doors can do. The weatherproof aluminium cladding protects your door from all environmental influences from the outside, allowing you to enjoy a long lifespan for your door.

Due to the tested multi-point locking mechanism with heavy hardware technology, the AC20 DO system can even be implemented as a hinged door weighing up to 300 kg and offers you optimum burglary protection up to security class RC2.

Configure your door freely according to the individual requirements of your project. You have full freedom of design.

All our entrance door systems can easily be equipped with extra-system accessories such as integrated overhead door closers, motorised swing door drives, anti-panic locks or automated access controls by card, fingerprint or numerical code.





Air Infiltration DIN 12207
Class 3



Driving Rain Resistance DIN 12208
Class 8A



Windload DIN 12210
Class C2



Acoustic Control
up to class 4



Thermal Insulation
 $\geq 0,80 \text{ W/m}^2\text{K}$



Burglar Resistance
RC1, RC2N, RC2

Fully concealed
fixing of interior
glass beads

Wide range of
regional types of wood

Anti-panic hardware
according to
DIN 179, DIN 1225

Barrier-free
threshold

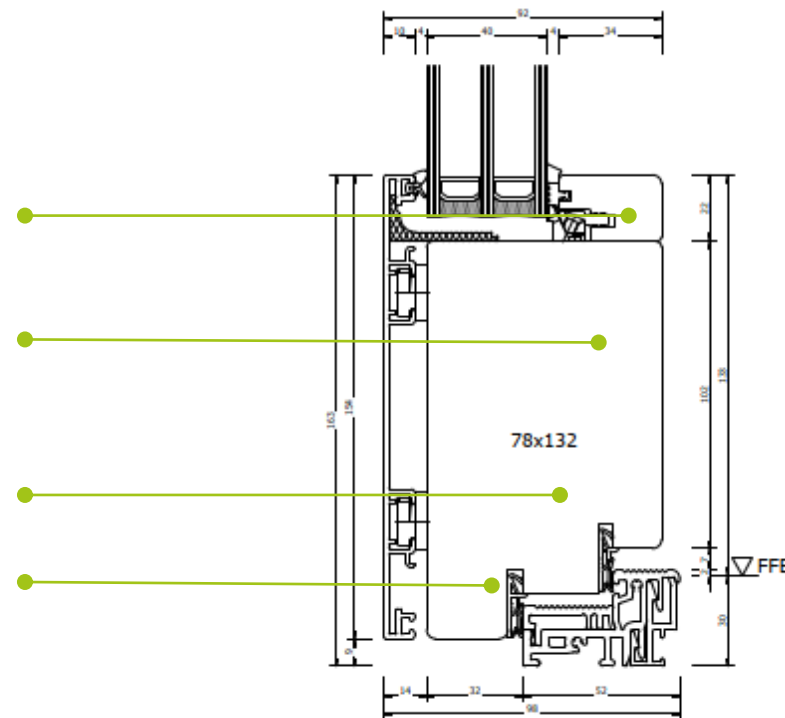

VISION. HIGHLIGHT.

The AC20 DO system is a winning combination of practicality, technological design and energy efficiency and meets the highest quality requirements worldwide.

It impresses with its elegant, flush appearance on the outside and therefore ideally complements modern building architecture.





Wood is one of the few raw materials capable of creating a tangible and visible sense of comfort that immerses the room atmosphere in a special mood.





FT-VILSTAL GMBH

Headquarters

Hammerbergstrasse 4
92286 Rieden/Vilshofen
Germany

phone: +49 151 428 59901

fax: +49 9624 4741169

Mail: export@ft-vilstal.com

Offices

Haßlinghauser Str. 156
58285 Gevelsberg
Germany

Industriestraße 1, Building B25
77731 Willstätt
Germany

Production

Martinshöhe 5
92277 Hohenburg
Germany

Kindinger Str. 53
85110 Kipfenberg
Germany



Telephone:
01473 677488

Email:
hello@okohaus.co.uk

Visit us online:
www.okohaus.co.uk

